

內徑

分精密級、一般級和鉸刀用3種

I.D.

Made in 3 different tolerances for precise drilling, normal drilling and reaming.

外徑

以內徑為基準，經精密研磨加工而成，分固定式襯套及插入式襯套

O.D.

Highly precise finish based on I.D.

(Press Fit Bush...P6) (Renewable Bush...m5)

硬度

HRC60° 以上耐磨度極高

HARDNESS

HRC 60° up for long-er life.

襯套 BUSH

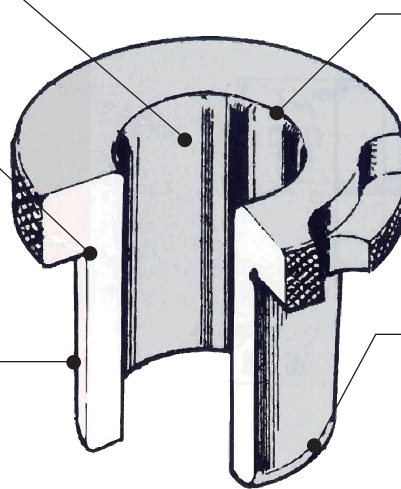

R圓

提供容易滑入之引導作用

RADIUS

For smooth entry of tool.

倒角

為了襯套之容易裝配故施以倒角加工

CHAMFER

Permit easy entry and removal.

治具用襯套 TYPE

形狀及種類 TYPE AND APPLICATION

S...精密鉗頭用

R...鉸刀用

S...Precise drilling R...Reaming

| 名稱 Designation | 固定襯套 Press Fit | | 插入式襯套 Renewable Bush | | | | 引導用 固定式襯套 Headless Liner bush | 止動螺絲 Lock Screw | 止動環 Round Clamp | |
|-----------------------------|--|---------------|-------------------------|-----------------------|---|--------------|--|--------------------|--------------------|----|
| | 無帽緣 Headless | 付帽緣 Headed | 圓形 Round | 右向迴轉切口形 Right Slip | 左向迴轉切口形 Left Slip | 切口形 Fixed | | | | |
| 形狀 Shape | | | | | | | | | | |
| 內徑的使用 Sort of I.D. | 精密級鉗頭 Precise Drilling | SA | SB | SC | SD | SE | SF | G形 | T形 | R形 |
| | 一般級鉗頭 Normal Drilling | A | B | C | D | E | F | | | |
| | 鉸刀 Reaming | - | BR | CR | DR | ER | FR | | | |
| 使用方法 Illustration of use | 無帽緣(A) Headless | | 無帽緣(B) Headed | | 插入式(C) | 插入式(D) | 插入式(E) | 插入式(F) | | |
| | AB型襯套均以緊密配合平均壓入 Press the bush into the plate | | | | 先將固定襯套G以緊密配合壓入治具板後再用手裝取插入式襯套並配以T形螺絲固定 First press the liner bush into the plate, the insert the bush and set the lock screw. | | | | | |
| | | | | | | | | | | |

內徑與外徑的同軸度 Concentricity of ID and OD

| 內徑 (d) 寸法 ID(d) | 1.6~18.0 | 18.1~50.0 | 50.1~55.0 |
|--|----------|-----------|-----------|
| 精密級 / 鉗孔 Precise drilling/ reaming | 0.005 | 0.008 | 0.010 |
| 一般級 Normal Drilling | 0.012 | 0.020 | 0.025 |

與治具板之裝配公差 Assembly tolerance with bush plate

| 襯套承板的內徑尺寸 I.D.(d) of hole in bush plate | 0.3~3.0 | 3.1~6.0 | 6.1~10.0 | 10.1~18.0 | 18.1~30.0 | 30.1~50.0 | 50.1~55.0 |
|--|-------------|-------------|-------------|-------------|-------------|-------------|-------------|
| H7公差 Tolerance H7 | +0.010 0 | +0.012 0 | +0.015 0 | +0.018 0 | +0.021 0 | +0.025 0 | +0.030 0 |

■ T.止動螺絲 LOCK SCREW

購買時請告知型式如:T-5。

- T-5 之牙距有0.8(ISO)和0.9(JIS)兩種。
- 本公司標準品採用0.8，如需要0.9時，請說明告知。
- T-5 is available in P=0.8 (ISO) and P=0.9 (JIS)
- When ordering T-5 (P=0.9) , Please specify P (pitch) 0.9

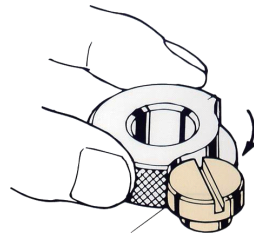
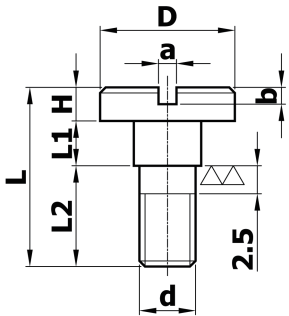
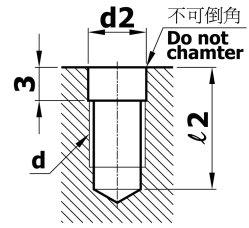

T 型止動螺絲
T-LOCK SCREW

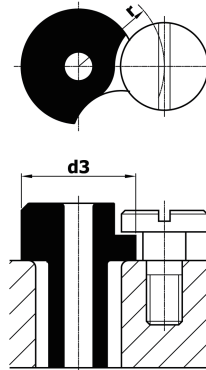

| d3 | d | r | | d2 | L2 |
|----|----|---------|--------------|-----|----|
| | | 尺寸 Size | 公差 Tolerance | | |
| 16 | M5 | 12 | ±0.2 | 5.2 | 11 |
| 19 | | 13.5 | | | |
| 22 | | 15 | | | |
| 26 | | 17 | | | |
| 30 | M6 | 19 | ±0.3 | 6.2 | 14 |
| 35 | | 22 | | | |
| 40 | | 24.5 | | | |
| 47 | M8 | 28 | ±0.3 | 8.2 | 16 |
| 55 | | 33 | | | |
| 62 | | 36.5 | | | |
| 69 | | 40 | | | |
| 77 | | 44 | | | |

| 規格 MODEL | d | | d1 | | D | | a | b | H | L1 | | L2 | L |
|-------------|------------|-------------|------------|-----------------|------------|-----------------|-----|------|---|------------|-----------------|------|-----|
| | 尺寸 SIZE | 牙距 Pitch | 尺寸 SIZE | 公差 Tolerance | 尺寸 SIZE | 公差 Tolerance | | | | 尺寸 SIZE | 公差 Tolerance | | |
| T-5 | M5 | 0.8(0.9) | 6 | +0.2 | 12 | +0.2 | 1.6 | 1.5 | 3 | 4 | +0.1 | 9 | 16 |
| T-6 | M6 | 1 | 7 | | 15 | | | 2 | 4 | 5.5 | | 10.5 | 20 |
| T-8 | M8 | 1.25 | 9 | | 18 | | | +0.3 | 2 | 2.5 | | 5 | 6.5 |

■ R.止動環 ROUND CLAMP

- 本止動環請用於高負荷迴轉之插入式襯套。
- 裝置尺寸與位置相同於T行止動螺絲之裝置尺寸與位置，請參考尺寸圖表。
- The round clamp can be used in place of lock screw Type T to prevent round of renewable bush (Type D、E and f).
- The round clamp is also used in case heavier round is put on renewable bush.

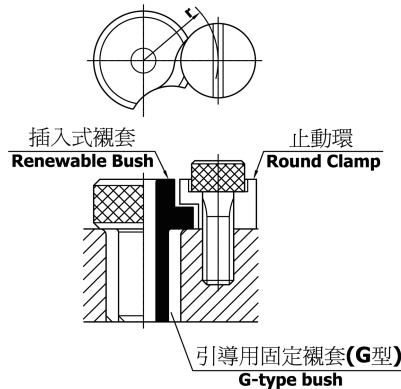
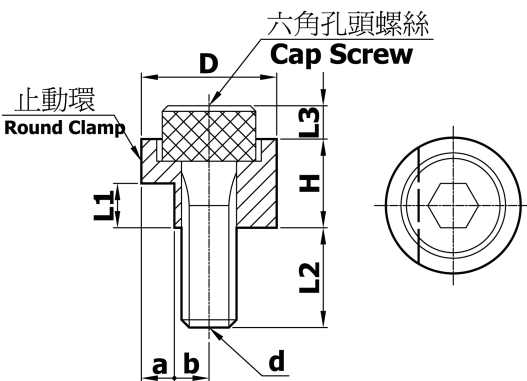

| 規格 MODEL | d | | D | | a | | b | H | L1 | L2 | L3 | 六角孔頭螺絲 Cap Screw |
|-------------|------------|-------------|------------|-----------------|------------|-----------------|------|----|-----|------|-----|---------------------|
| | 尺寸 SIZE | 牙距 Pitch | 尺寸 SIZE | 公差 Tolerance | 尺寸 SIZE | 公差 Tolerance | | | | | | |
| R-5 | 5 | 0.8 | 12.3 | ±0.05 | 3 | 0 -0.1 | 3.15 | 8 | 4 | 9 | 3 | M5x15 |
| R-6 | 6 | 1 | 15.5 | | 4 | | 3.75 | 12 | 5.5 | 8 | 2 | M6x16 |
| R-8 | 8 | 1.25 | 19.5 | | 5 | | 4.75 | 15 | 6.5 | 10.5 | 2.5 | M8x20 |