

THER 小徑刀把

THER SLIM COLLET CHUCK



Balancing / 動平衡

G6.3

SK40
Max.25,000 RPM
Or U ≤ 1gmm

Option / 選配
G2.5

SK40
Max.25,000 RPM
Or U ≤ 1gmm

G6.3

SK50
Max.20,000 RPM
Or U ≤ 1gmm

Option / 選配
G2.5

SK50
Max.20,000 RPM
Or U ≤ 1gmm

Dimensions / 尺寸標示

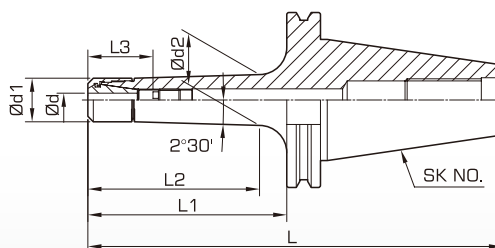

page.146

page.144

page.120

page.149



Nut
螺帽



Screw
調整螺絲



Collet
筒夾



Wrench
扳手

Tool
Clamping
Depth L3
刀具夾持
深度

Order No. 訂購編號	Range Range 夾持範圍	Ød1	Ød2	L	L1	L2	Tool Clamping Depth L3 刀具夾持 深度	Nut 螺帽	Screw 調整螺絲	Collet 筒夾	Wrench 扳手	
SK40	THER11-100	1.0~7.0	16	20.9	100	80.9	73.2	19~48	CAP-THER11	ER-M11	ER11-HP	PHS-20-RO160
	THER11-130	1.0~7.0	16	23.5	130	110.9	103.2	19~48	CAP-THER11	ER-M11	ER11-HP	PHS-20-RO160
	THER11-160	1.0~7.0	16	26.2	160	140.9	133.2	19~48	CAP-THER11	ER-M11	ER11-HP	PHS-20-RO160
	THER16-100	1.0~10.0	22	26.8	100	80.9	76.1	29~58	CAP-THER16	ER-M16	ER16-HP	PHS-20-RO220
	THER16-130	1.0~10.0	22	29.4	130	110.9	106.1	29~58	CAP-THER16	ER-M16	ER16-HP	PHS-20-RO220
	THER16-160	1.0~10.0	22	32	160	140.9	136.1	29~58	CAP-THER16	ER-M16	ER16-HP	PHS-20-RO220
SK50	THER11-100	1.0~7.0	16	20.3	100	80.9	66.6	19~48	CAP-THER11	ER-M11	ER11-HP	PHS-20-RO160
	THER11-130	1.0~7.0	16	22.9	130	110.9	96.6	19~48	CAP-THER11	ER-M11	ER11-HP	PHS-20-RO160
	THER11-160	1.0~7.0	16	25.6	160	140.9	126.6	19~48	CAP-THER11	ER-M11	ER11-HP	PHS-20-RO160
	THER16-100	1.0~10.0	22	26	100	80.9	66.6	29~58	CAP-THER16	ER-M16	ER16-HP	PHS-20-RO220
	THER16-130	1.0~10.0	22	28.6	130	110.9	96.6	29~58	CAP-THER16	ER-M16	ER16-HP	PHS-20-RO220
	THER16-160	1.0~10.0	22	31.2	160	140.9	126.6	29~58	CAP-THER16	ER-M16	ER16-HP	PHS-20-RO220

Remarks / 備註

- 需配合 3μ HP 筒夾 With 3μ HP Grade Collet
- 若需出水型刀把，請參考 page.26 選用說明
- 筒夾夾持為一對一整數值

Applications / 應用



Drilling
鑽孔



Reaming
銜孔



Tapping
攻牙



Mini Diameter
小徑加工